

DESIGN SPECIFICATION	
CYLINDER MODEL	PFL 215-04-150HT
CYLINDER SIZE	2" DIAMETER
CYLINDER WORKING VOLUME	150ml
TOTAL CYLINDER VOLUME	166ml
CYLINDER TARE WEIGHT	2.53 lbs
DESIGN PRESSURE	260 psi
DESIGN TEMPERATURE	250F/121C
INTERNAL FINISH	10ra, MIRROR, ELECTROPOLISH
EXTERNAL FINISH	10ra, MIRROR, ELECTROPOLISH
FILLPORT	SWAGELOK, 1/2 VCR
INLET VALVE	SWAGELOK, SS-4H-TW
OUTLET VALVE	SWAGELOK, SS-4H-TW
THERMOWELL	NO
DIPTUBE	YES
MATERIAL OF CONSTRUCTION	316L SS
TEST PRESSURE	520 psi
D.O.T. SPECIFICATION	4B-260
TOLERANCE (UNLESS OTHERWISE SPECIFIED)	±.060

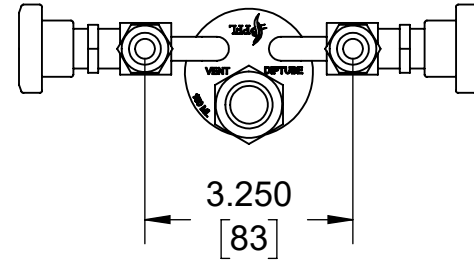

ZONE	REV.	DESCRIPTION	DATE	APPROVED
	1	INITIAL RELEASE	06/30/2014	
	2	HIGH TEMP	9/18/2020	

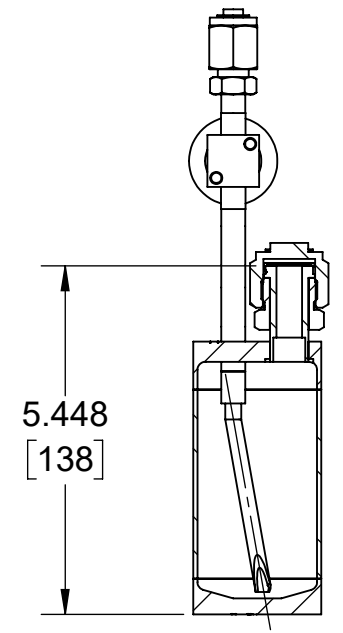
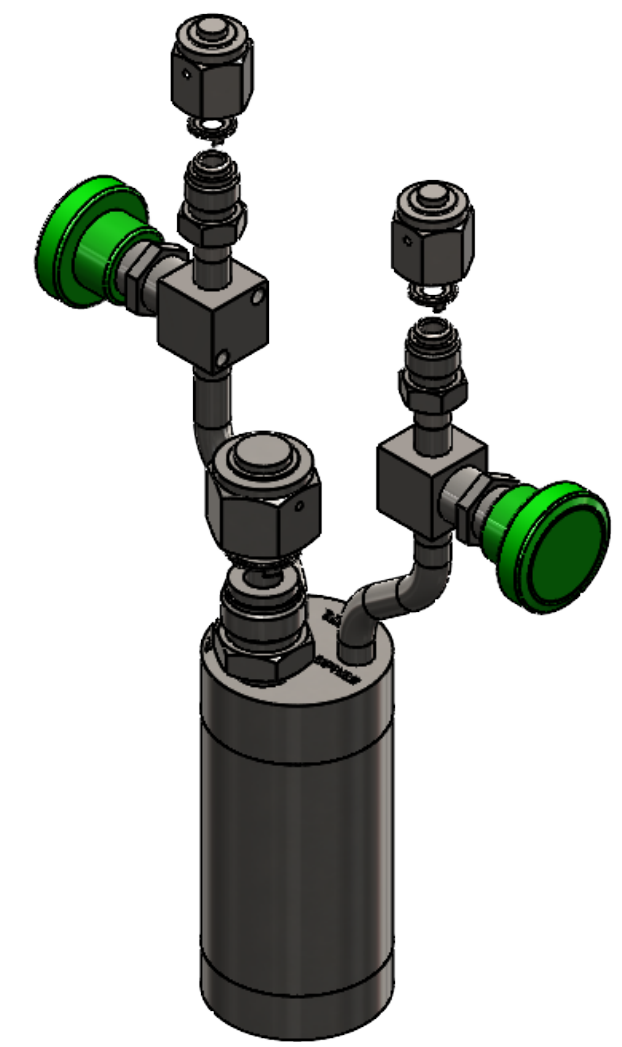

SECTION A-A

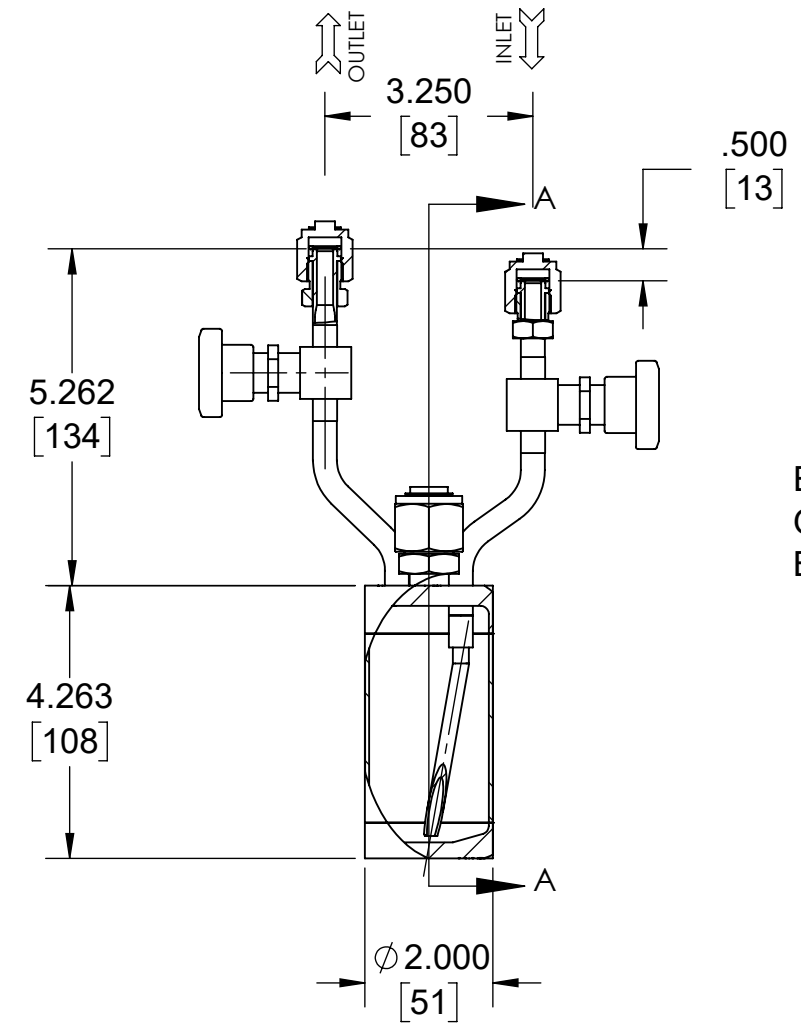

.500  
[13]



EREZTECH LOGO  
ON CYLINDER  
BODY

TOLERANCES UNLESS OTHERWISE SPECIFIED		INTERPRET GEOMETRIC TOLERANCING PER THIRD ANGLE PROJECTION		<b>PRECISION FABRICATORS LTD.</b> 171 TOSCA DRIVE STOUGHTON, MA 02072 (781) 341-7241 PHONE (781) 341-7245 FAX	
ANGULAR:	±0.5° ±0°30'	UNLESS OTHERWISE SPECIFIED: PRIMARY DIMENSIONS ARE INCH. ALTERNATE UNITS ARE MM.			
ONE PLACE DECIMAL:	±.1in [±.254mm]	DRAWN DBD 9/18/2020		TITLE: PFL 215-04-150HT	
TWO PLACE DECIMAL:	±.01in [±.25mm]	CHECKED DBD		CUSTOMER DWG(2)	
THREE PLACE DECIMAL:	±.005in [±.127mm]	ENG APPR. DBD		SIZE B DWG. NO. 0215-04 - 150CC	
BREAK ALL SHARP CORNERS: R.02/01in [R.50/.25mm]		MFG APPR. EJY		REV 2	
SURFACE FINISH: 63 ✓ [1.6] ✓		Q.A.		DO NOT SCALE DRAWING	
<b>NOTICE OF CONFIDENTIAL INFORMATION</b> INFORMATION CONTAINED HEREIN IS CONFIDENTIAL AND IS THE PROPERTY OF PRECISION FABRICATORS LTD. WHERE FURNISHED WITH A PROPOSAL THE RECIPIENT SHALL USE IT SOLELY TO EVALUATE THE PROPOSAL. WHERE FURNISHED TO A CUSTOMER IT SHALL BE USED SOLELY FOR PURPOSES OF INSPECTION INSTALLATION, OR MAINTENANCE. WHERE FURNISHED TO A SUPPLIER IT SHALL BE USED SOLELY IN THE PERFORMANCE OF WORK CONTRACTED FOR BY THIS COMPANY. THE INFORMATION SHALL NOT BE USED OR DISCLOSED BY THE RECIPIENT FOR ANY OTHER PURPOSE WHATSOEVER.		SCALE: 1:3		SHEET 2 OF 13	